

LATE REPRESENTATIONS FOR COMMITTEE

Committee Date: 27.04.2017

App No:

SL/2017/0087;
SL/2017/0088 and
SL/2015/0695

Site Address:

Wood End Farm, KIRKBY
LONSDALE

APPLICATION DETAILS:

SL/2015/0695 Reserve Matter for Demolition of farm buildings and the erection of 9 dwellings with associated landscaping and modified access

Additional Location Plan

REPRESENTATIONS:

Neighbour: concerns over traffic impact from the new development onto the access road which will cause safety issues. The development should be limited to conversion of the existing barn buildings and subdivision of the farmhouse, being a more appropriate density for the existing infrastructure. Should be 100% affordable

OFFICERS COMMENTS:

SL/2015/0695 Reserve Matter application was not formally itemised on front sheet.

The representation made by a neighbour does not alter the conclusions within the Committee Report with regard to the affordable housing or traffic.

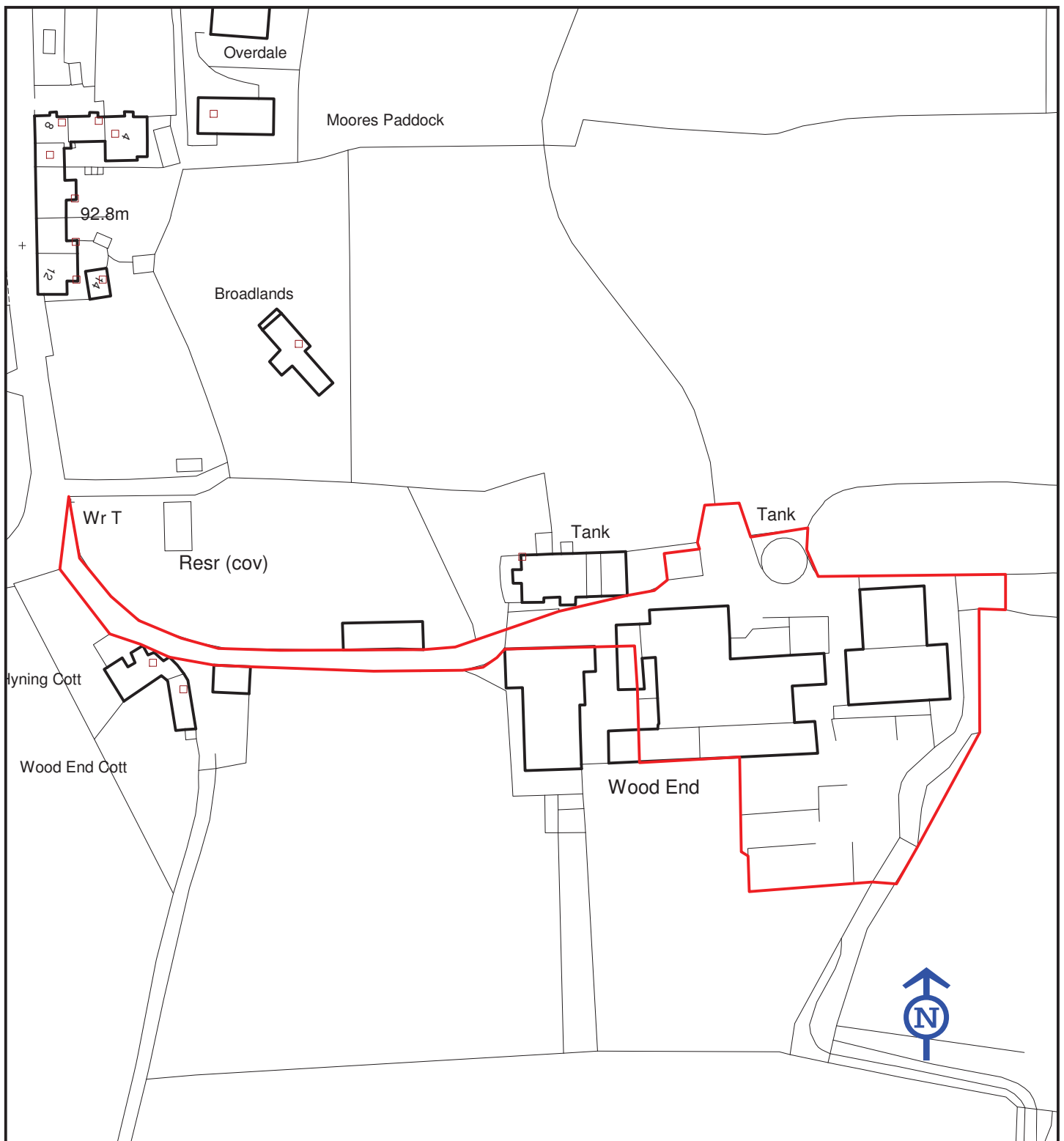

The material contained in this plot has been reproduced from an Ordnance Survey map with permission of the Controller of Her Majesty's Stationery Office. Licence No. 100024277 © Crown Copyright

Unauthorised reproduction infringes Crown Copyright and may lead to prosecution or civil proceedings

Development Control Group
 South Lakeland District Council
 South Lakeland House
 Lowther Street
 KENDAL, Cumbria LA9 4DL

**PLAN REFERRED TO:
 SL/2015/0695**

Scale 1:1250

**Wood End Farm
 Low Biggins
 KIRKBY LONSDALE
 LA6 2DH**

April 2017