



**Lake District
National Park**

7/2018/5722

TOWN AND COUNTRY PLANNING ACT 1990

NOTICE OF GRANT OF PLANNING PERMISSION

To: Mr David Key
DK Designs
Kiln Head Cottage
Lambrigg
Kendal
LA8 0DG

PART 1 - PARTICULARS OF APPLICATION

- | | | |
|---|--|--|
| 1 | Name and address of applicant | Mr Stuart Hunter - Lake District Estates Co. Ltd., Maudlands, Maude Street, Kendal, LA84QD |
| 2 | Date of application | 5 December 2018 |
| 3 | Land to be developed | Hill of Oaks Caravan Park, Tower Wood, Cumbria, LA12 8NR |
| 4 | Development forming the subject of the application | Variation of condition 2 (plans) on planning application 7/2018/5228 - Remove rotten and all timber decking and piles from 2 timber jetties and provide as replacement jetties to match existing together with 10m extensions to each jetty. |

PART 2 - PARTICULARS OF DECISION

IN PURSUANCE of their powers under the Town and Country Planning Act 1990, the Lake District National Park Authority as local planning authority **HEREBY GIVE NOTICE THAT PLANNING PERMISSION** for the development referred to in Part 1 hereof **HAS BEEN GRANTED**.

SAVE as hereunder specified the development shall be carried out and completed in entire accordance with the particulars specified in the application and plans submitted. The development shall be subject to the following conditions:

- 1 The development hereby permitted shall be commenced before 14 June 2021.

REASON: Imposed in accordance with the provisions of Section 91 of the Town and Country Planning Act, 1990.

- 2 The development hereby permitted shall not be carried out otherwise than in conformity with the following submitted plans and details:



Notice of variation with introductory note

The Environmental Permitting (England & Wales) Regulations 2016

Lake District Estates Company

Flood Risk Activity (a) the construction of a new boathouse on Lake Windermere, River Levens (Main River)

Flood Risk Activity (a) the construction of two jetties on Lake Windermere, River Levens (Main River)

Flood Risk Activity (a) the erection of a temporary cofferdam on Lake Windermere, River Levens (Main River)

National grid reference(s): SD3828890446

Hill of Oaks Caravan Park, Newby Bridge, Ulverston, LA12 8NR

Variation application number

EPR/BB3558MY-V04

Permit number

EPR/BB3558MY

South Lakeland District Council

Lake Wardens Office
Ferry Nab
Bowness-on-Windermere
Cumbria LA23 3JH

Tel: 015394 42753
Fax: 015394 47813

e-mail: lake.wardens@southlakeland.gov.uk

APPLICATION FOR AN ENCROACHMENT ON THE BED OF WINDERMERE

Encroachment No.....

Name of Applicant.....Lake District Estates Co Ltd

Address Maudlands, Maude Street. Kendal. Cumbria LA9 4QD

Telephone No...01539739090.....

Name of Agent..... Tony Hills, Damson Consultancy Ltd

Telephone No..... 015395 61763

Name of Contractor...Jetties and Moorings Ltd

Telephone No 015395 31341.....

Location of Proposed Encroachment (inc O.S. grid Ref) Lake frontage of Hill of Oaks Holiday Park

Newby Bridge, Ulverston, LA12 8NR Grid Ref SD3828890446

**5 COPIES OF THE LOCATION PLAN AND DIMENSIONS
TO BE SUBMITTED AT TIME OF APPLICATION**

Details of Proposed Encroachment..... **Pier**

(a) Method and Type of Construction : Treated timber piles and deck: Refer to Construction Method Statement

.....
(b) Dimensions: **Length**37.8m (10m extension) **Width:**1.5m

(c) Is the proposed Encroachment to be used Commercially as part of Holiday Park facilities

Names and Addresses of adjoining land owners

1).....

.....

2).....

.....

All Applications Must include certified copies of plans and permissions granted by the Lake District National Park Authority,(Planning Consent) and The Environment Agency, together with the fee of £226.80p inc.vat.

Signed  Date 10 3 22



Hill of Oaks , Jetties Newby Bridge,, LA12 8NR

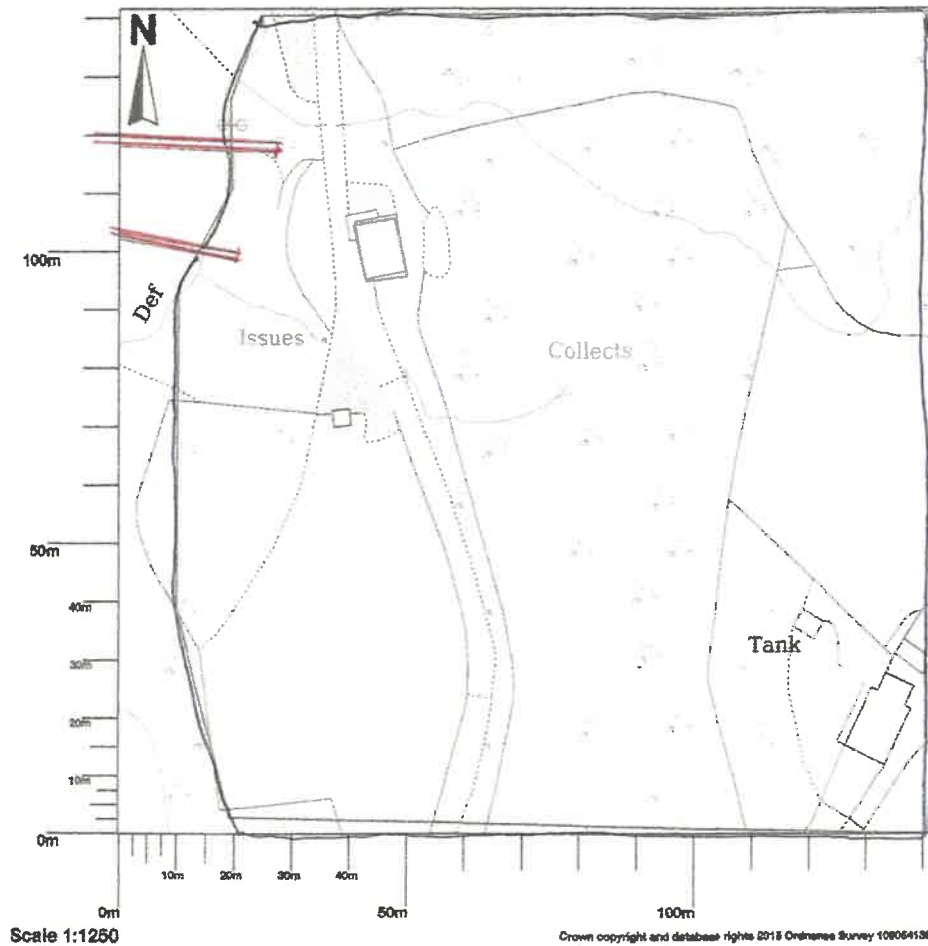

Map shows area bounded by: 338321.28,489818.28,338462.72,489959.72 (at a scale of 1:1250) The representation of a road, track or path is no evidence of a right of way. The representation of features as lines is no evidence of a property boundary.

Produced on 04 November 2015 from the Ordnance Survey National Geographic Database and incorporating surveyed revision available at this date. Reproduction in whole or part is prohibited without the prior permission of Ordnance Survey. © Crown copyright 2015. Supplied by UKPlanningMaps.com a licensed Ordnance Survey partner (100054135). Unique plan reference: p2b/61635/86049

Ordnance Survey and the OS Symbol are registered trademarks of Ordnance Survey, the national mapping agency of Great Britain. UKPlanningMaps logo and other designs are Copyright © copla ltd 2015

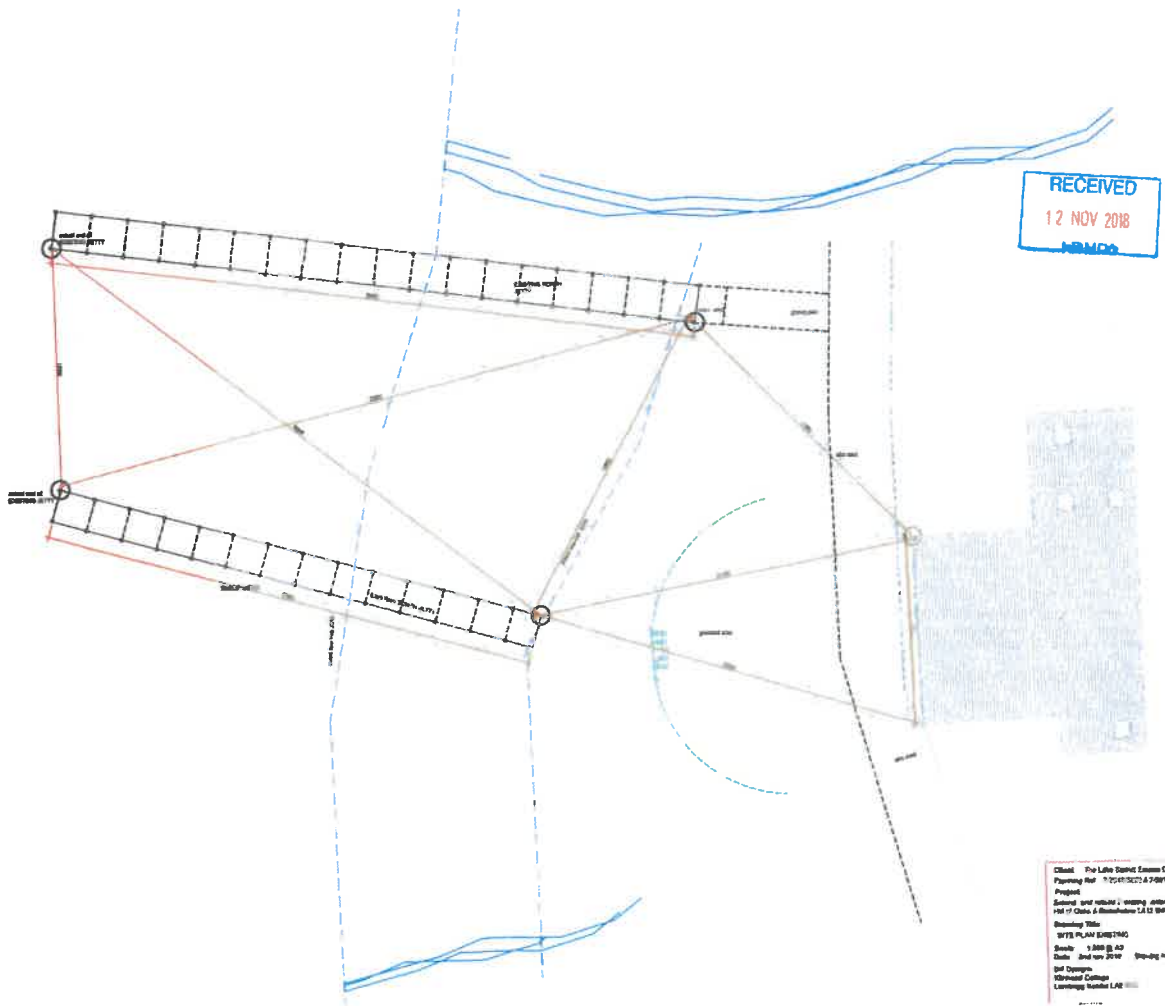

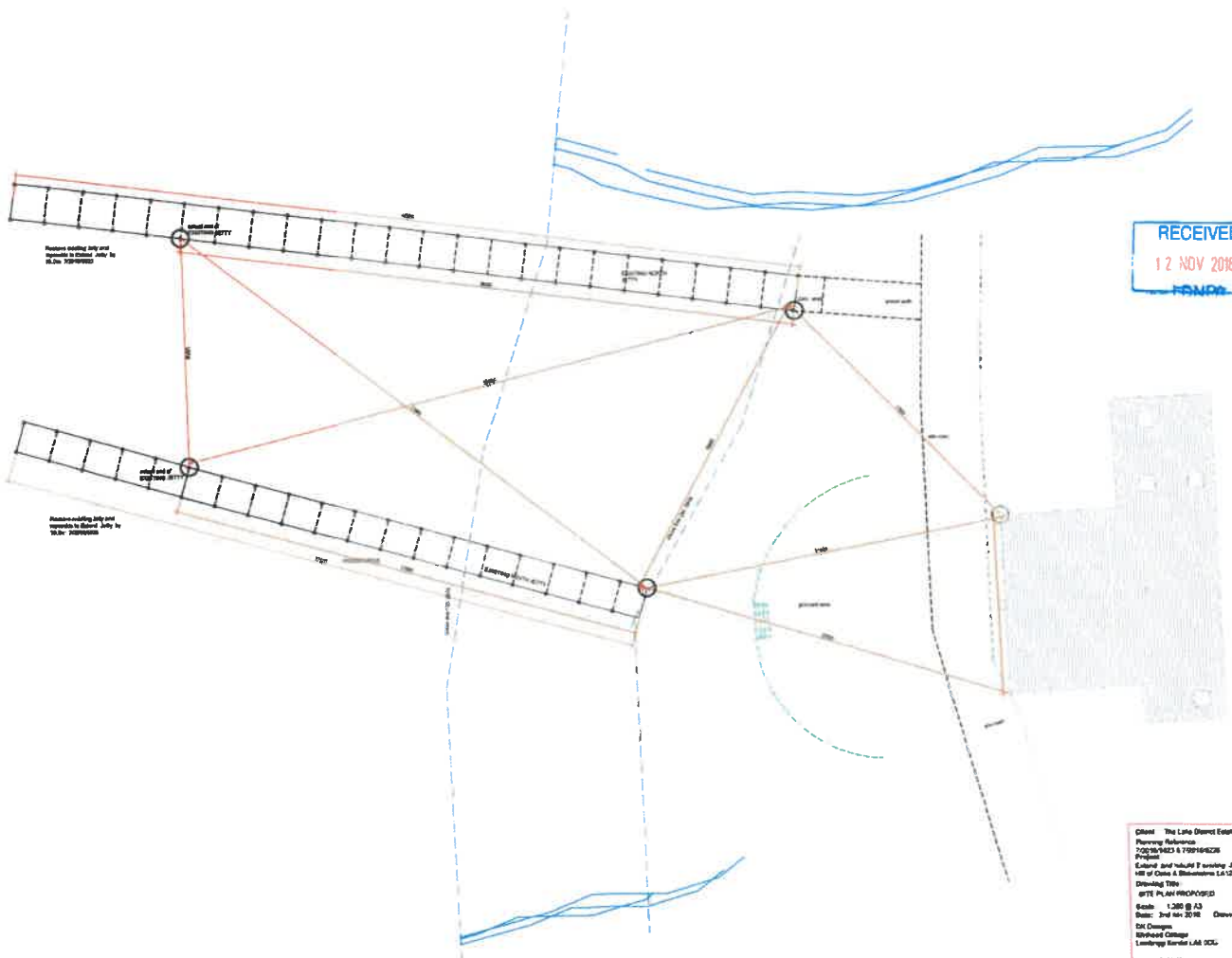

RECEIVED
12 NOV 2018
ESMP

Client: The Lingo District Estates Co. Ltd
Planning Reference: 722/18/0423 & 729/18/0226
Project: Cultural and Industrial Park, Jiffrey Hill of Queens & Blackheath, LA12 9AP
Drawing Title: SITE PLAN PROPOSED
Scale: 1:500 @ A3
Date: 2nd Nov 2018 Drawn by: Jk
DK Design
100 Woodlands
Leamington Spa CV32 3JL
J02 b